



Collare d'appoggio PE100

Estremità per saldatura nel bicchiere

PE100 stub flange

Female sockets fusion

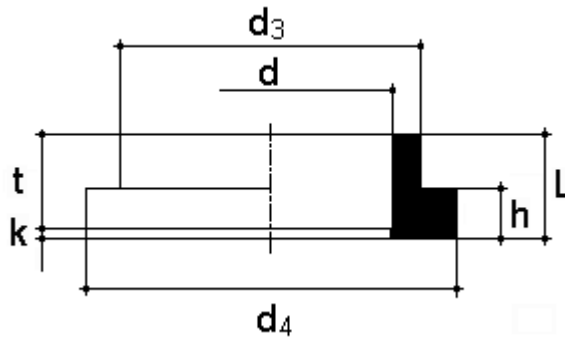

d (mm)	L (mm)	d ₃ (mm)	d ₄ (mm)	h (mm)	k (mm)	t (mm)	Peso Weight (kg)	PN (bar)
20	19,0±1,5	27,0±1,0	45,0 ±1,0	10,0±1,0	5,0±1,0	14,5±1,0	0,15	16
25	21,0±1,5	33,0±1,0	58,0 ±1,0	10,0±1,0	5,0±1,0	16,0±1,0	0,20	16
32	25,0±1,5	41,0±1,0	68,0 ±1,0	10,0±1,0	6,0±1,0	19,0±1,0	0,24	16
40	26,5±1,5	50,0±1,0	78,0 ±1,0	10,5±1,0	4,0±1,0	22,5±1,0	0,40	16
50	29,0±1,5	61,0±1,0	88,0 ±1,0	13,0±1,0	5,5±1,0	23,5±1,0	0,50	16
63	33,5±1,5	76,0±1,0	102,0±1,0	14,0±1,0	5,0±1,0	28,5±1,0	0,60	16
75	38,0±1,5	91,0±1,0	122,0±1,0	16,0±1,0	7,5±1,0	30,5±1,0	0,70	16
90	42,0±1,5	109,0±1,0	138,0±1,0	17,0±1,0	6,5±1,0	35,5±1,0	0,80	16
110	46,5±1,5	131,0±1,0	158,0±1,0	18,0±1,0	5,0±1,0	41,5±1,0	1,00	16

Materiale: PE 100

Colore: nero

Idoneo per linee chimiche, acqua e gas

Material: PE 100

Colour: black

Suitable for chemical, water and gas piping system